

GP200-12 12V200Ah

Sealed Rechargeable Gel-Tech Battery



SPECIFICATIONS

| | |
|------------------------------------|--|
| Cells Per Unit | 6 |
| Voltage Per Unit | 12 |
| Capacity | 200Ah@10hr-rate to 1.80V per cell@25°C |
| Weight | Approx. 58.3kg |
| Max. Discharge Current | 1200A (5sec) |
| Internal Resistance | Approx. 2.9mΩ |
| Operating Temperature Range | Discharge: -40°C~50°C Charge: -20°C~50°C Storage: -20°C~50°C |
| Normal Operating Temperature Range | 25°C±5°C |
| Float charging Voltage | 13.50 to 13.80V DC/unit Average at 25°C |
| Max. Charging Current | 50A |
| Equalization and Cycle service | 14.70 to 15.00V DC/unit Average at 25°C |
| Self Discharge | The batteries can be stored for more than 6 months at 25°C. Please charge batteries before using. For high temperature, the time interval will be shorter. |
| Terminal | T9 / T14 |
| Constainer Material | ABS(UL94-HB) Flammability resistance of UL94-V0 is available on request. |

APPLICATION

- Solar systems
- UPS systems
- IT systems
- Data centers
- Power generation plants and substations
- Telecommunication equipments



DIMENSIONS

Unit: mm

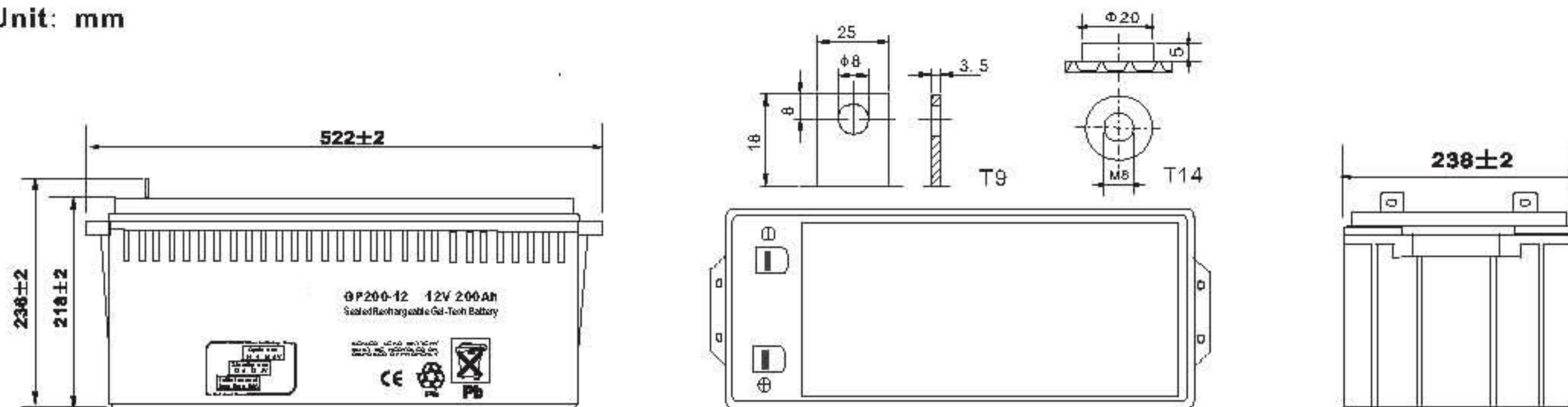

Constant Current Discharge Characteristics Unit:A(25°C,77°F)

| F.V/Time | 5min | 10min | 15min | 30min | 45min | 1h | 3h | 5h | 10h | 20h |
|------------|-------|-------|-------|-------|-------|-------|------|------|------|------|
| 1.60V/cell | 570.0 | 451.9 | 345.1 | 208.5 | 152.6 | 112.5 | 55.7 | 34.5 | 20.6 | 10.7 |
| 1.65V/cell | 546.8 | 409.4 | 337.7 | 204.8 | 150.9 | 111.5 | 55.5 | 34.4 | 20.5 | 10.5 |
| 1.70V/cell | 496.3 | 395.1 | 332.8 | 203.4 | 149.1 | 110.5 | 55.2 | 34.2 | 20.2 | 10.4 |
| 1.75V/cell | 448.2 | 363.8 | 323.4 | 201.6 | 144.3 | 110.0 | 55.0 | 34.0 | 20.0 | 10.2 |
| 1.80V/cell | 407.6 | 337.9 | 300.1 | 189.7 | 142.9 | 104.5 | 51.0 | 32.5 | 17.5 | 9.5 |

Constant Power Discharge Characteristics Unit:W(25°C,77°F)

| F.V/Time | 5min | 10min | 15min | 30min | 45min | 1h | 3h | 5h | 10h | 20h |
|------------|-------|-------|-------|-------|-------|-------|-------|------|------|------|
| 1.60V/cell | 940.8 | 725.7 | 641.8 | 399.1 | 301.0 | 212.7 | 105.3 | 65.1 | 40.9 | 21.5 |
| 1.65V/cell | 901.6 | 721.3 | 637.7 | 387.0 | 298.3 | 210.7 | 104.2 | 65.0 | 40.4 | 20.4 |
| 1.70V/cell | 842.8 | 703.7 | 625.3 | 379.0 | 290.3 | 209.6 | 103.6 | 64.4 | 40.1 | 20.3 |
| 1.75V/cell | 784.0 | 659.7 | 584.2 | 358.8 | 287.7 | 207.5 | 103.3 | 64.2 | 39.8 | 20.2 |
| 1.80V/cell | 705.6 | 615.8 | 551.3 | 354.8 | 279.6 | 197.2 | 95.8 | 61.1 | 35.1 | 19.0 |

All mentioned values are average values.

GP200-12 12V200Ah

TEMPERATURE EFFECTS CURVE

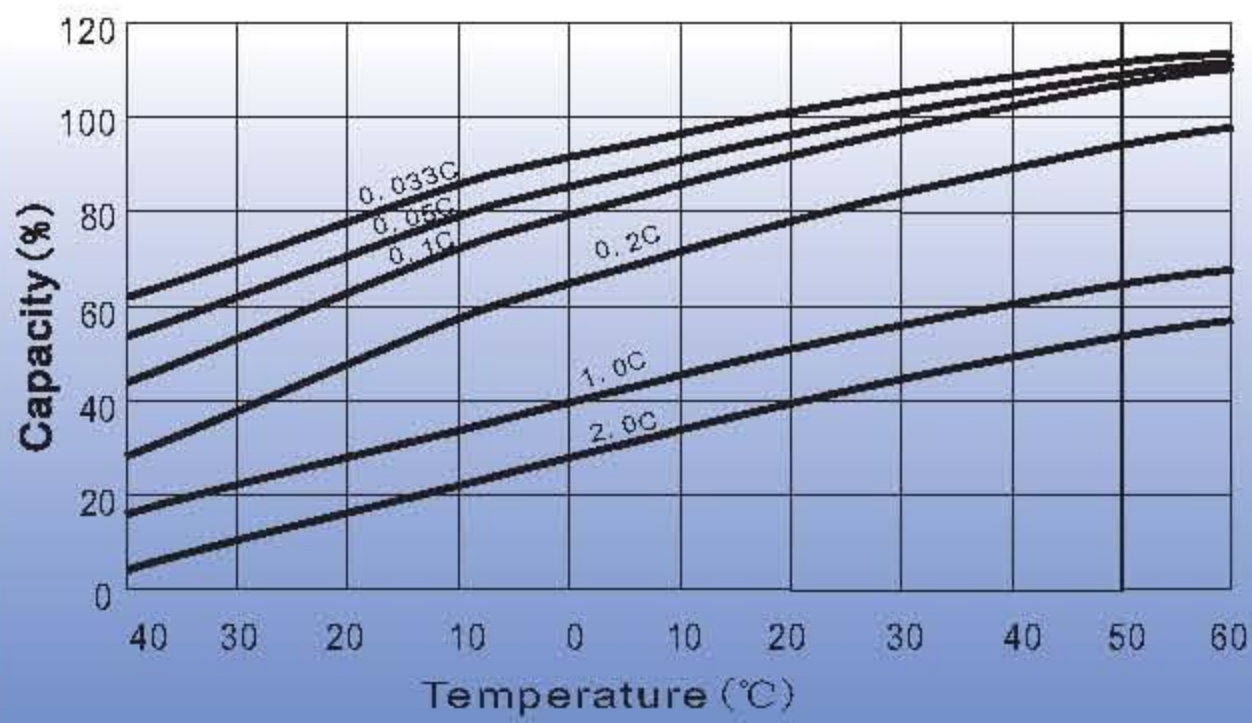

DISCHARGE TIME VS. DISCHARGE CURRENT (25°C)

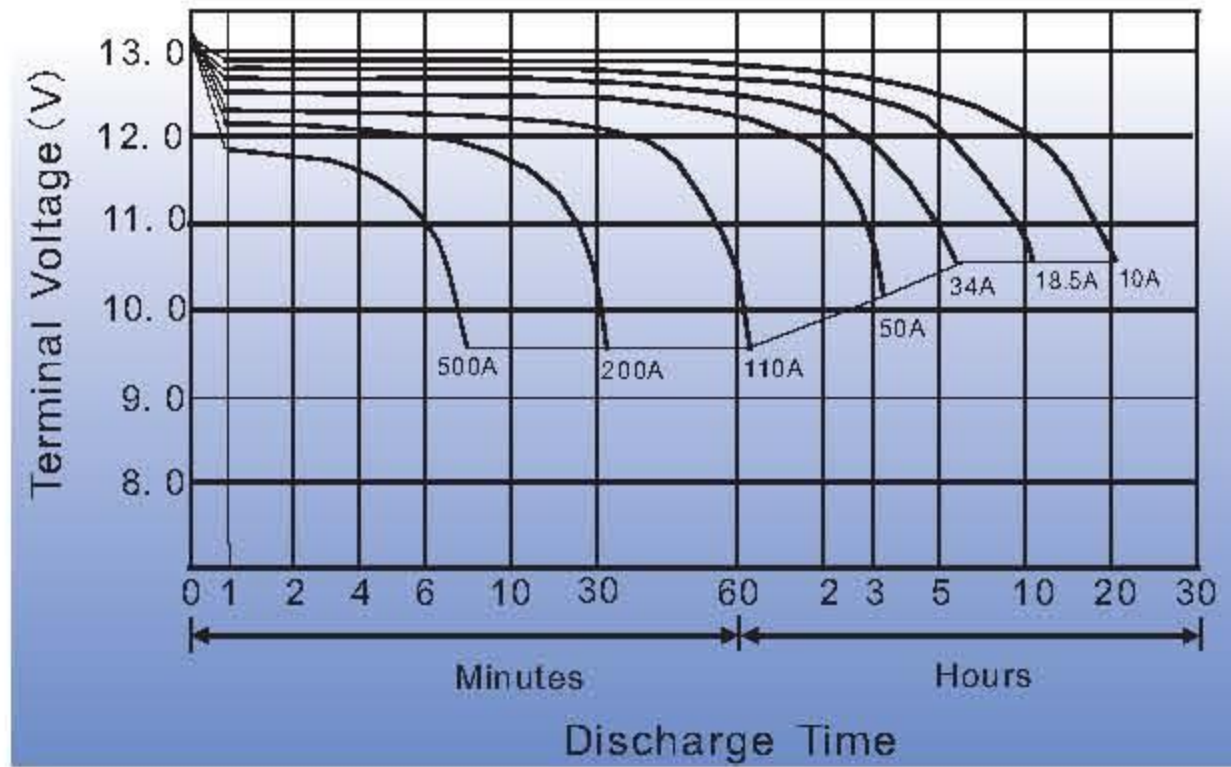

LIFE CHARACTERISTICS OF CYCLIC USE

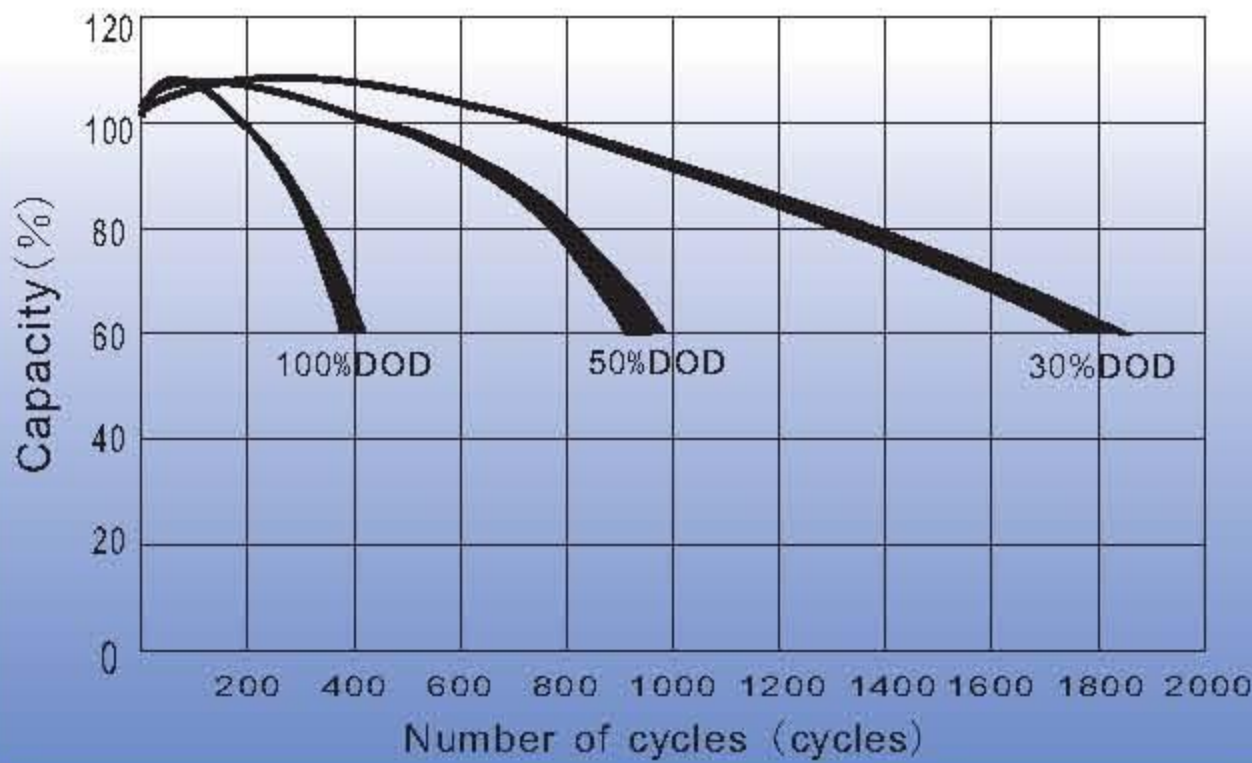

SELF-DISCHARGE CHARACTERISTIC

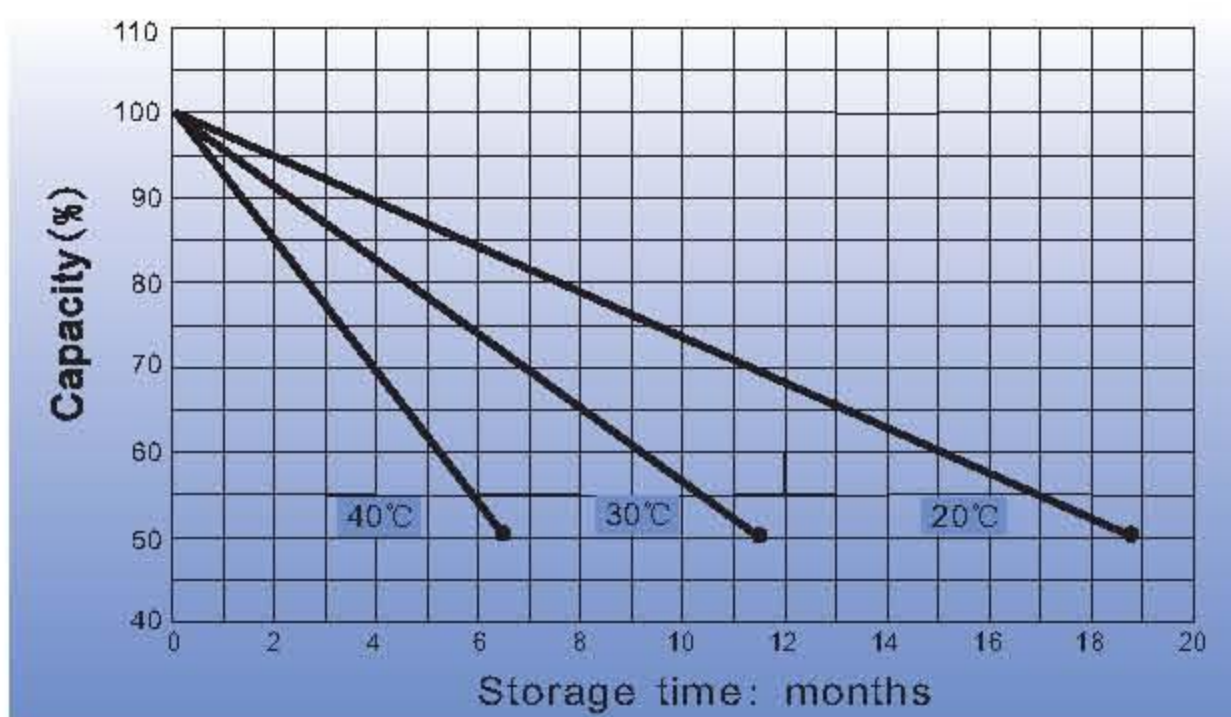

EFFECT OF TEMPERATURE ON LONG TERM FLOAT LIFE

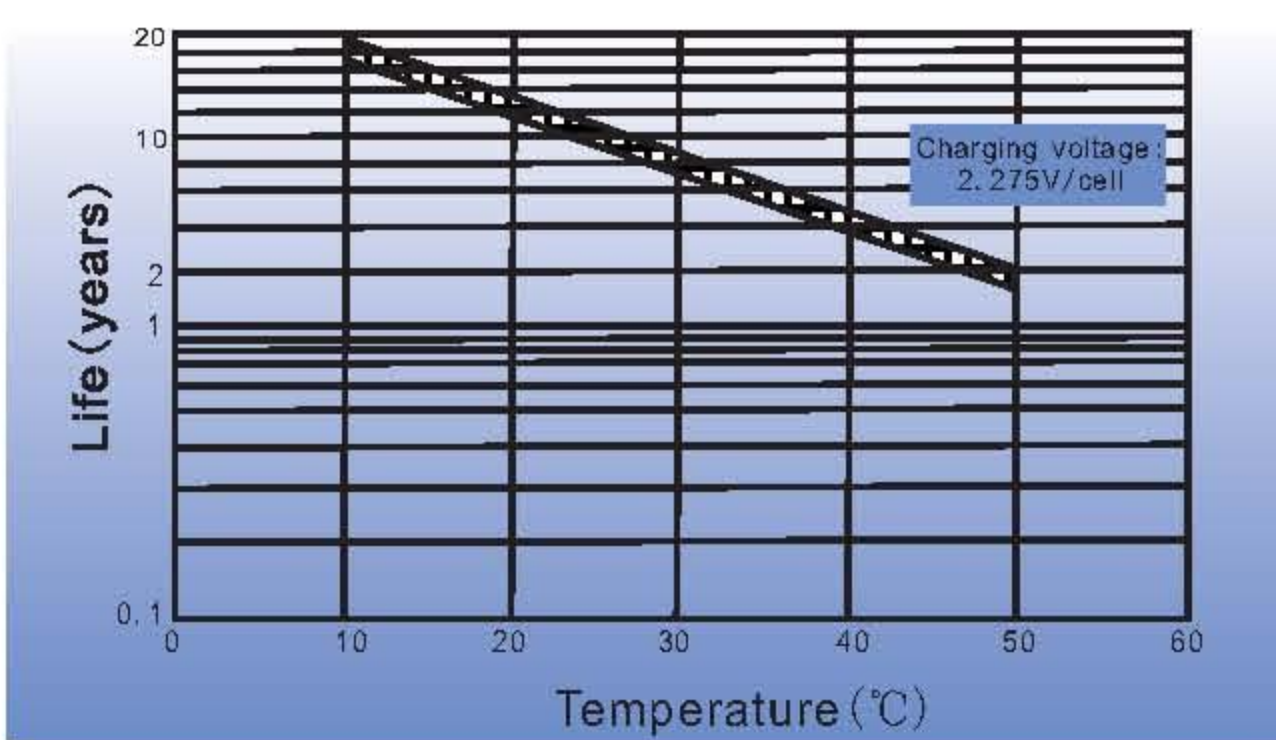

CHARGE CHARACTERISTIC CURVE FOR STANDBY USE

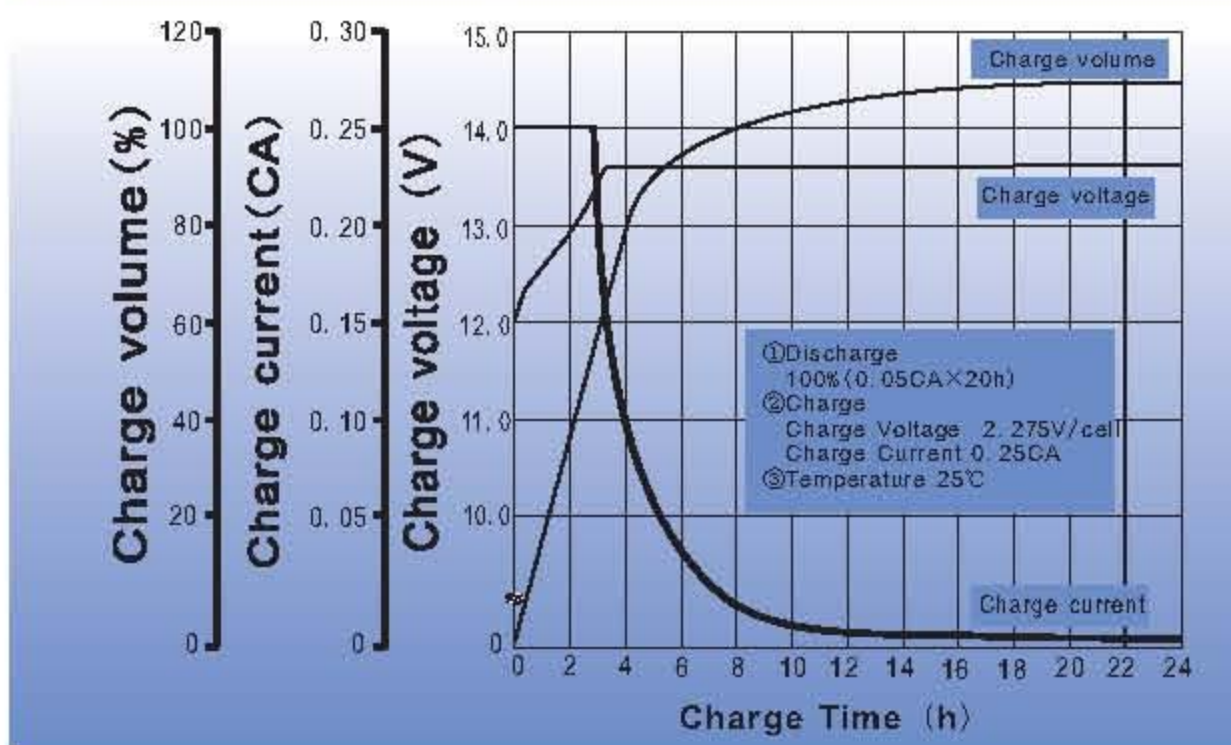

Charging Procedures

| Application | Charge Voltage (V/cell) | | | Max. Charge Current |
|-------------|-------------------------|-----------|------------------|---------------------|
| | Temperature | Set Point | Allow able Range | |
| Cycle Use | 25°C | 2.475 | 2.45~2.50 | 0.25C |
| Standby Use | 25°C | 2.275 | 2.25~2.30 | |

Charge the batteries at least once every 6 months, if they are stored at 25°C.

Charging Method

| | |
|------------------|--|
| Constant Voltage | 14.7~15.0V, 5~11h, Max. Current 0.25CA |
| Constant Current | 0.1CA×5h |
| Fast | 0.25CA×1.7h |

Discharge Current VS. Discharge Voltage

| | | | | |
|--------------------------------|------------|-------------------|-------------------|------------|
| Final Discharge Voltage V/cell | 1.75 | 1.7 | 1.6 | 1.3 |
| Discharge Current(A) | 0.2C > (A) | 0.2C < (A) < 0.5C | 0.5C < (A) < 1.0C | (A) > 1.0C |

Sales Office

Multistar Electronics LLC
Naif road, Deira, Dubai, UAE
TEL: 0097142296401