

# FACEPASS 7

Touchless Face Recognition System



<0.5s



WiFi



Mask Detection

FacePass 7 facial recognition terminal is equipped with AI deep learning Architecture and infrared live detection technology, which can achieve 24/7 accurate identification for virous environment conditions and can effectively prevent fake faces such as photos and videos.

Through the verification of more than one million people in different countries around the world, FacePass 7 has become one of the most accurate devices to identify the world's racial races. FacePass 7 uses a new Linux CPU, the face capturing time is less than one second, and the recognition time is less than 0.5 seconds. The super wide HD camera can realize flexible and rapid recognition at multiple angles and distances.

FacePass 7 can communicate through a variety of WIFI, 4G or wired network, and can be managed through its own Web-server and PC based professional software.

# FACEPASS7

Touchless Face Recognition System

## Technical Specifications

Capacity	User Capacity	3,000
	Card Capacity	3,000
	Log Capacity	100,000
Interface	Communication	TCP/IP, RS485, USB Host, WiFi, Optional 4G
	I/O	Relay Output, Wiegand Output, Door Sensor, Switch, Doorbell
Feature	Identification	Face, Card, ID+Password
	Verify Speed	<1s
	Image Display	Support
	Self-defined Status	10
	Record Self-check	Support
	Embedded Webserver	Support
	Doorbell	Support
	Multi-languages Support	Support
Hardware	Software	Crosschex Standard
	CPU	Dual-core 1.0GHz
	Camera	Dual Camera
	LCD	3.2" HD TFT Touch Screen
	LED Indicator	Support
	Sound	Support
	Angle Range	Level: ±20°, Vertical: ±20°
	Verify Distance	0.3-0.8 m (11.8-31.5 inch)
	RFID Card	Standard EM, Optional Mifare
	Tamper Alarm	Support
	Operating Temperature	-20 °C (-4 °F)- 60 °C (140 °F)
	Operating Voltage	DC 12V
	Dimensions (W x H x D)	124*155*92 mm (4.9*6.1*3.6 inch)
Operating Humidity	0% to 95%	

## System configurations

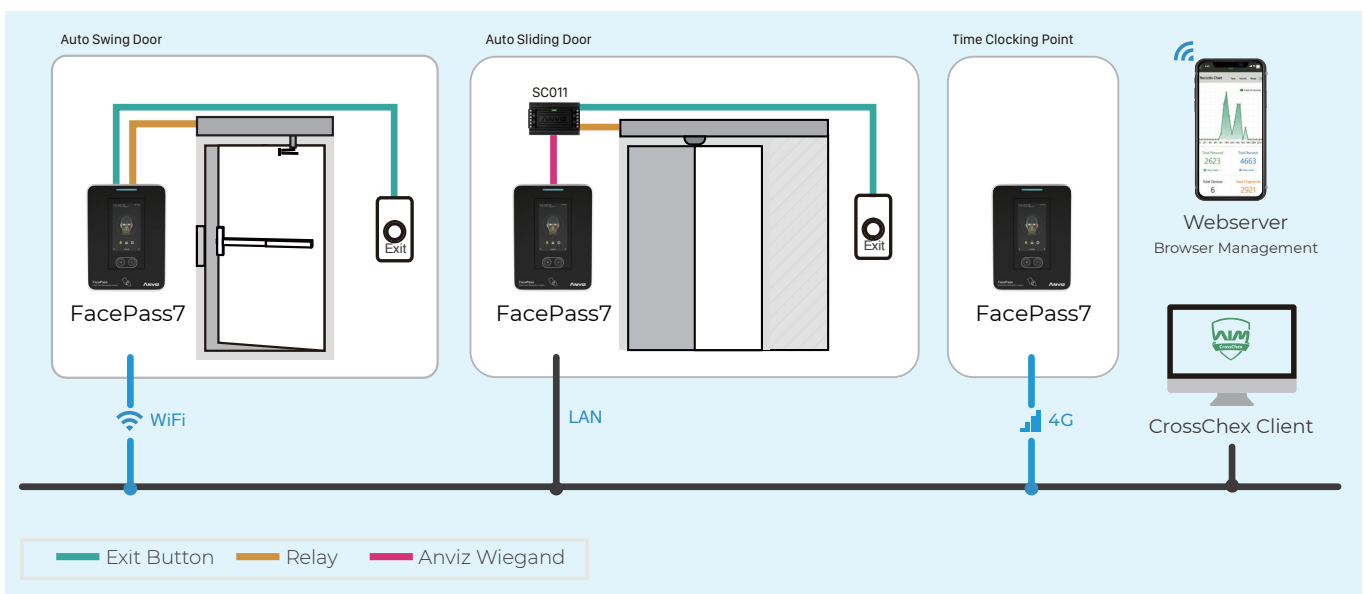

**ANVIZ**  
POWERING SMARTER WORLD

### Anviz Global Inc.

41656 Christy Street Fremont, Fremont, CA, 94538

Tel: 1-510-573-6552 | Toll-free: 1-855-268-4948 | [sales@anziv.com](mailto:sales@anziv.com) | [www.anviz.com](http://www.anviz.com)

©2020 Anviz Global Inc. Anviz and identifying product names and numbers herein are registered trademarks of Anviz Global Inc. All non-Anviz brands and product names are trademarks or registered trademarks of their respective companies. Product appearance, build status and/or specifications are subject to change without notice.

Due to the consistent improvement of the product, this specification and appearance are subject to change without notice.